

CONTACT: WENDY NIEFER

PHONE: 403-815-1115

EMAIL: WENDY@WENDYNIEFER.COM

WEBSITE: WWW.WENDYNIEFER.COM

MEASUREMENT SUMMARY AND ROOM DIMENSIONS

ADDRESS: 204, 69 SPRINGBOROUGH CT SW

CALGARY, ALBERTA

PROPERTY TYPE: APARTMENT

MEASURED ON: JANUARY 31, 2020

BEDROOMS: 1

BATHROOMS: 1

MAIN INFO

Main Floor Above Grade Area (RMS)	651.4sq.ft.	60.5sq.m.	9' Ceiling
Total RMS	651.4sq.ft.	60.5sq.m.	
Finished Below Grade	n/a		
Unfinished Below Grade	n/a		
Total Below Grade	n/a		
Exterior Wall Thickness	n/a		

MAIN FLOOR

Kitchen	11'2"x9'2"
Living Room	16'6"x13'9"
Dining Room	12'4"x7'1"
Master Bedroom	13'0"x12'1"
4pc Bathroom	12'9"x5'8"

AUXILIARY AREAS

Balcony	10'6"x7'6"
---------	------------

403-585-3839



CALGARY PHOTOS
WWW.CALGARYPHOTOS.CA

INFO@CALGARYPHOTOS.CA

All Measurements Certified, Guaranteed and Insured through True Area.
Areas are calculated using RECA RMS measurement standards and are covered under E&O through True Area.
True Area retains copyright and ownership of all measurements, payment by the client permits use for listing purposes.
This report is non-transferable and may not be re-sold.

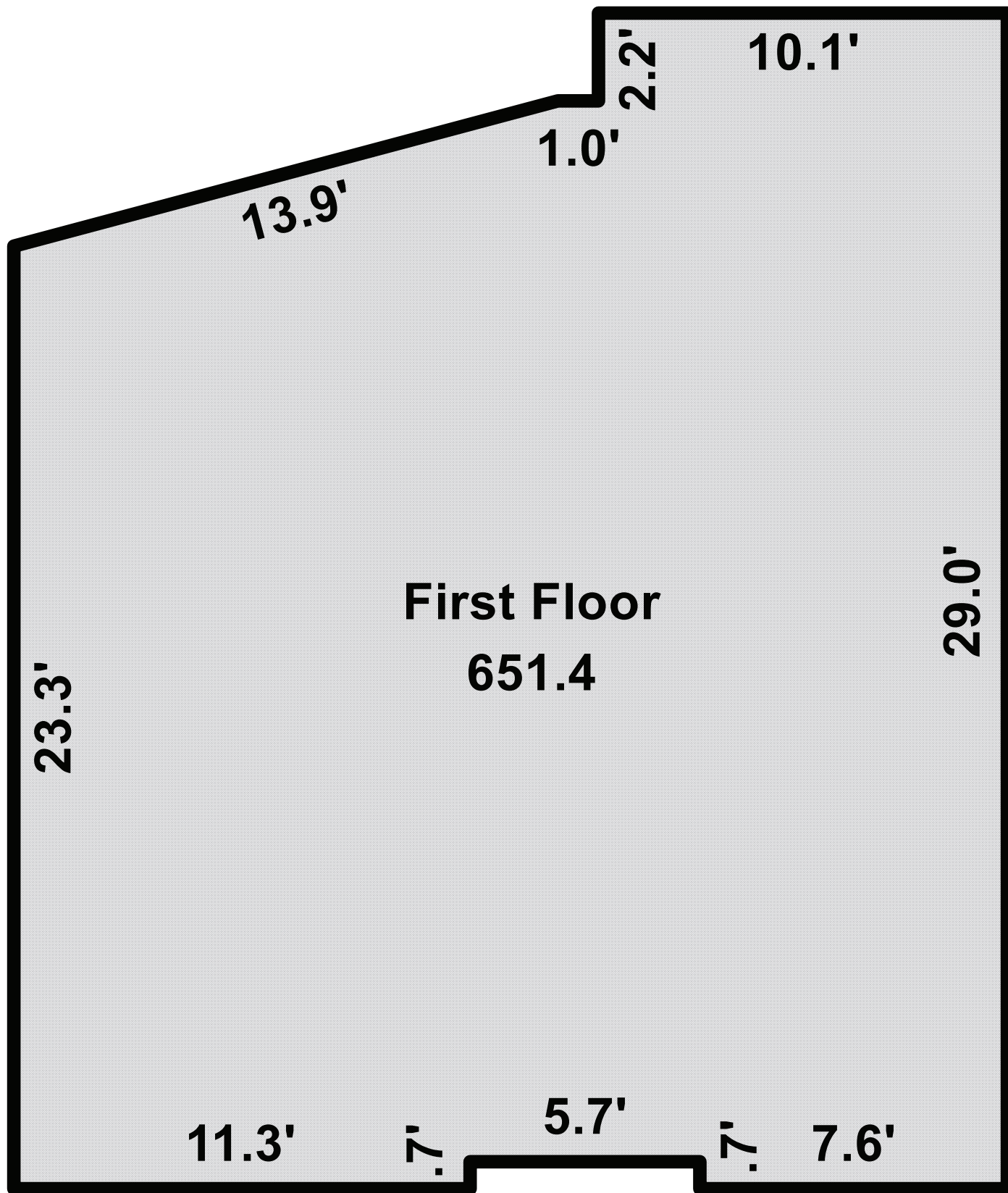

Measured by: Cory Moore/True Area

First Floor (GLA1)

$$24.50 \times 22.58 = 553.29$$

$$11.25 \times 0.67 = 7.50$$

$$7.58 \times 0.67 = 5.06$$

$$0.5 \times 13.89 \times 3.46 = 24.04$$

$$11.08 \times 3.58 = 39.72$$

$$10.08 \times 2.17 = 21.85$$